

Gammalux® Perimeter Series Direct (GPD) Wall Slot

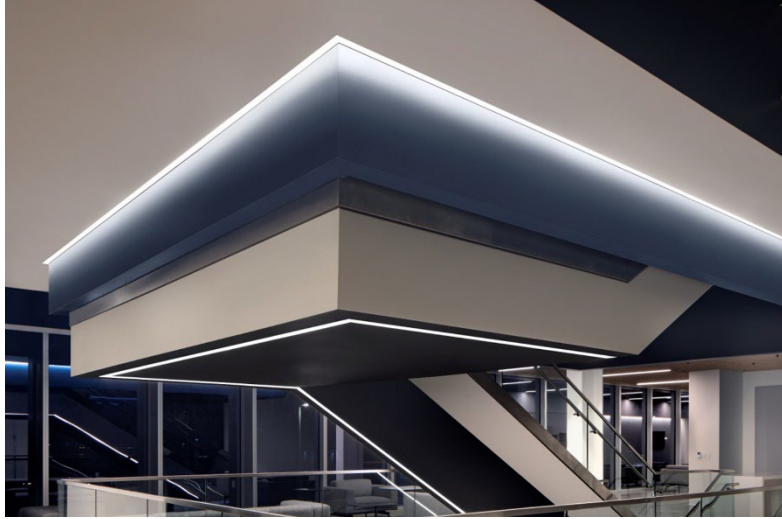

Continuous perimeter mounted lines of light including complex patterns. Click on any of the cross-section details below that correspond to your aperture requirements, then specify the amount of regress that meets *your design intent*.



GPD1
1.8" Housing Width
Regress 0", 1", 2"

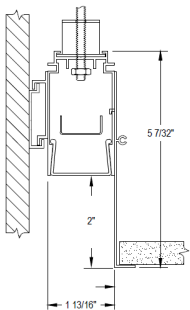

GPD2
2.4" Housing Width
Regress 0", 1", 2", 3"

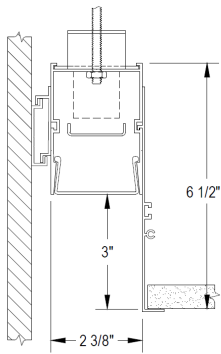

GPD3
3" Housing Width
Regress 0", 1", 2", 3"

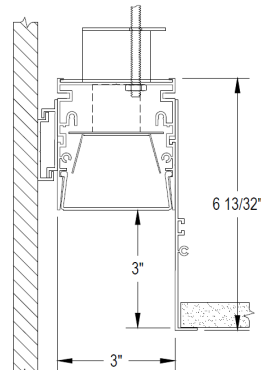

Click for:
**Asymmetric
To Room**

GPD4
4" Housing Width
Regress 0", 1", 2", 3"

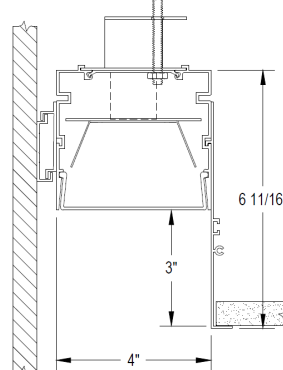

Click for:
**Asymmetric
To Room**

GPD5
5" Housing Width
Regress 0", 1", 2", 3"

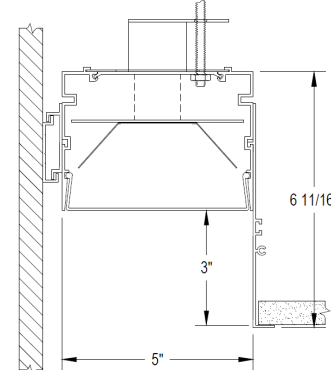

GPD6
6" Housing Width
Regress 0", 1", 2", 3"

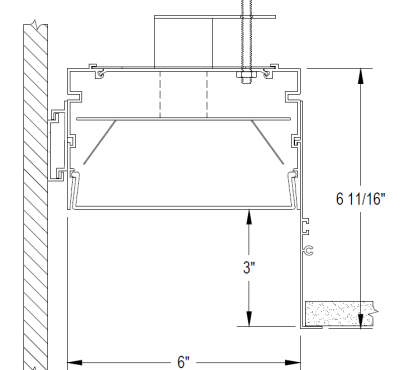

Click / scan for latest version

"Specifying Gammalux perimeter lighting systems is essential for problem-free installations!"

See page 2 for
**GAMMALUX
EZ-TELE™** and
links to videos

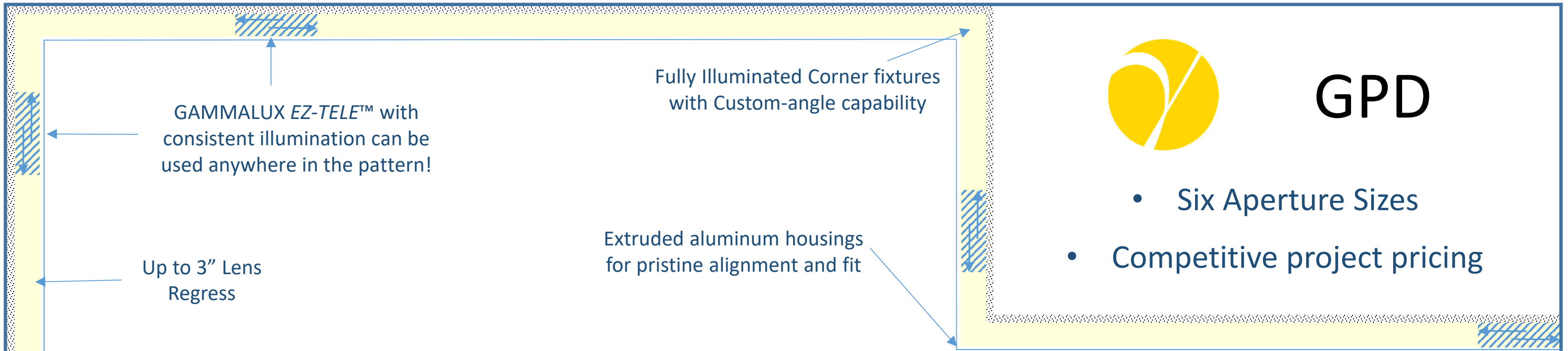

GAMMALUX EZ-TELE™ FOR SIMPLIFIED PERIMETER WALL SLOT INSTALLATIONS*** 
 = ***U.S. PATENT No. 11,384,923

- GPD IS DESIGNED FOR ACCELERATED CONSTRUCTION SCHEDULES
- JOURNEYMAN PRIMARY INSTALLATION & APPRENTICE FINAL TRIM OUT

• **FAST INSTALL**

• **LESS JOURNEYMAN LABOR REQUIRED**

• **CLEAN DESIGN**

**1-Minute
Specifier Video**

**3-Minute
Installer Video**

**10-Minute
Estimator Video**

**All GPD
Products**

“Specifying Gammalux perimeter lighting systems is essential for problem-free installations!”